

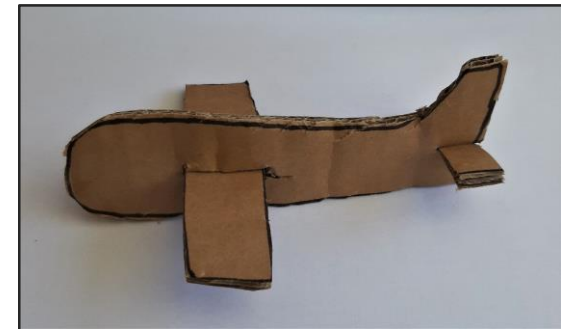

You will need

- Corrugated cardboard
- Rubber band
- Scissors
- Craft knife (optional)
- Glue gun and glue stick (or other strong glue)
- Colouring crayons or felt tip pens to decorate glider

You can use the glider template provided or design your own.



1 The Fuselage

This links all the parts together. On an aeroplane this is the space for passengers.

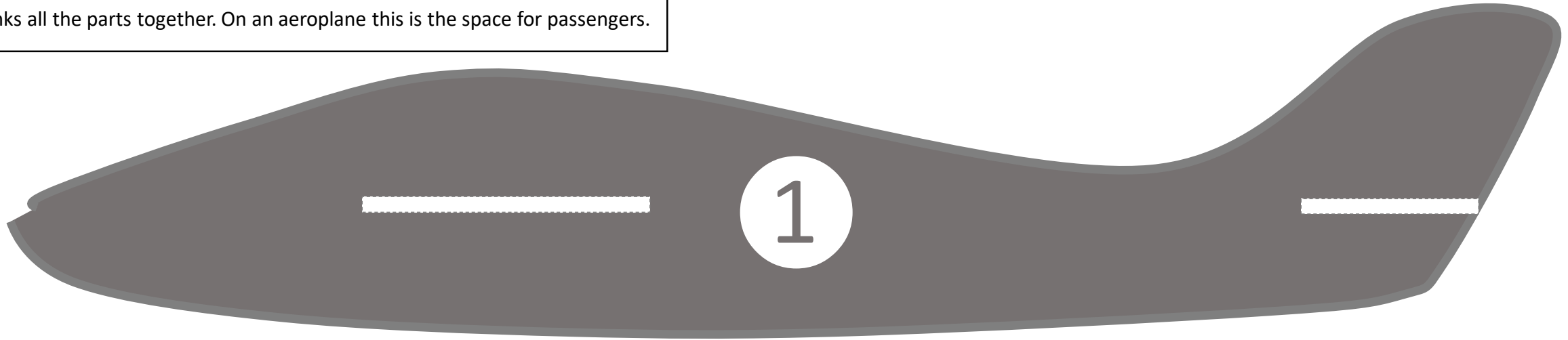

2 The Wings

These create the lift, allowing the glider to fly.



3 The Horizontal Stabiliser

This helps to make the glider stable in the nose-to-tail direction, preventing it tipping nose up or nose down..

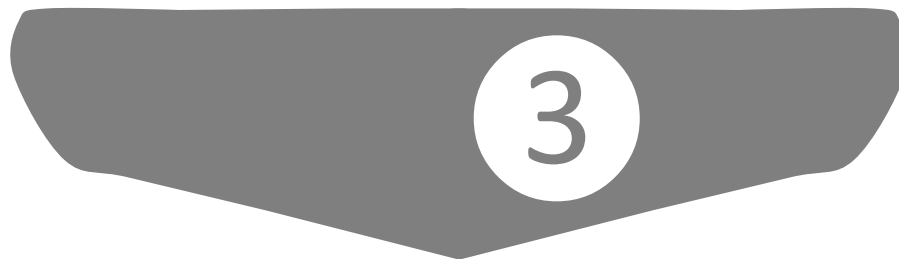

GLIDER AND LAUNCHER

1

Use the template or draw your own components of the glider to make outlines on the cardboard and cut them out carefully.

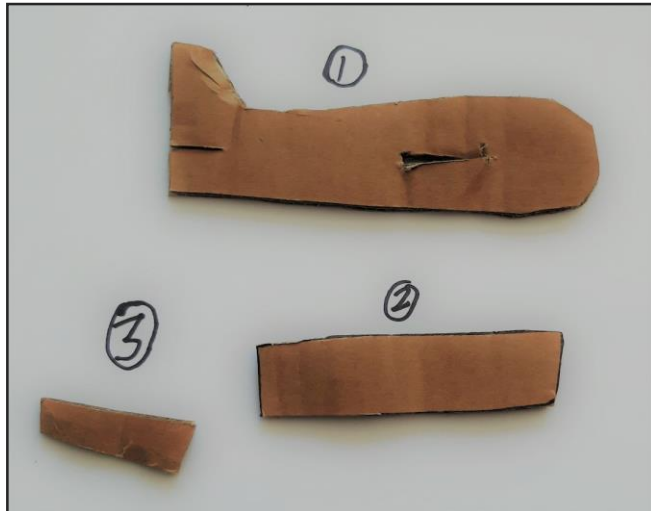

**Take care when handling scissors.
Craft knives should only be used under the
supervision of a responsible adult.**

2

If you would like to decorate the glider this is best done before the glider is put together.

Slide the wing **2**
and the horizontal
stabiliser **3**
into the fuselage.

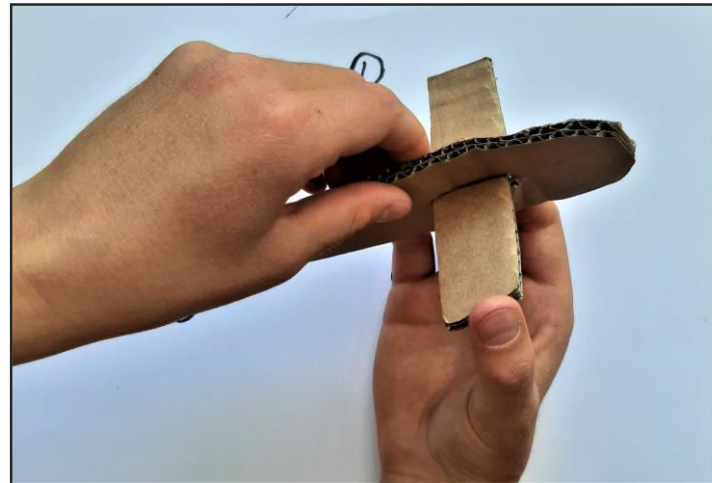
**3**

Cut a notch on the bottom of the fuselage, so you can launch the glider.

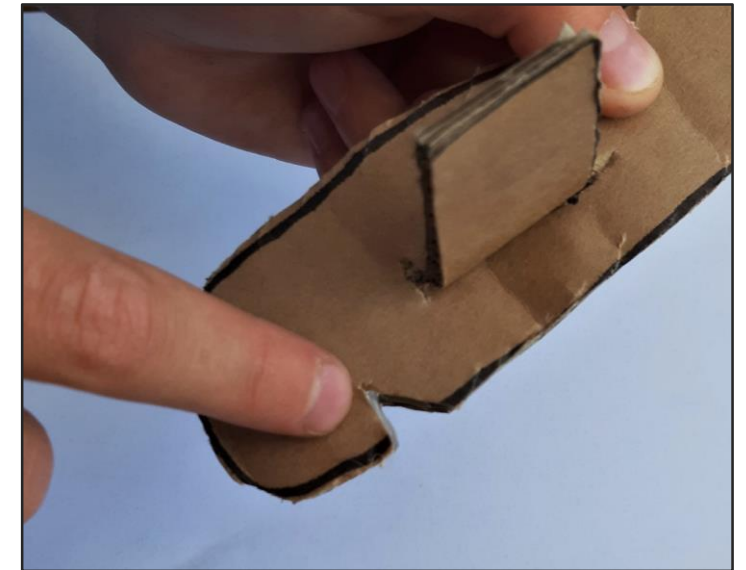
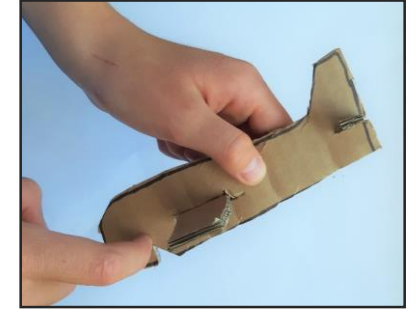

Add glue to the notch. This will protect it when you use the rubber band to launch the glider.

4

Glue the wing and horizontal stabilizer in place.

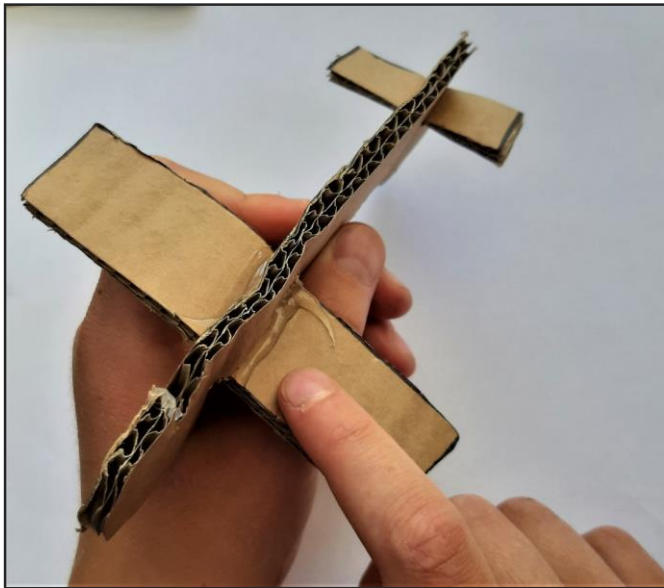

The glue will strengthen the glider so it does not tear or fall apart.

5

Separate the corrugated cardboard at the glider's nose carefully.
Glue a coin on the inside of the fuselage as shown in the photo below and then glue the cardboard back together.

You may need to use a heavier coin depending on the size of the glider

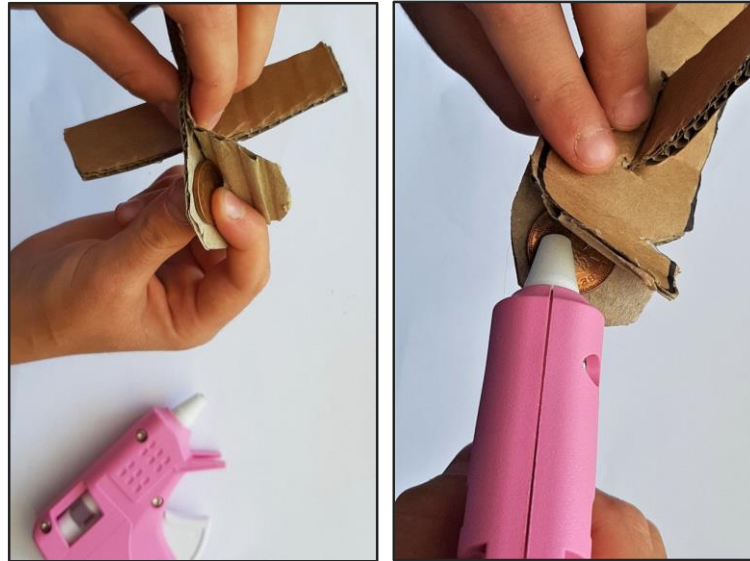

The nose weight is added to help bring the balance point (centre of gravity) of the glider to just in front of the wings. This helps the glider to be stable in the nose-to-tail direction.



Why do we
add a weight

?

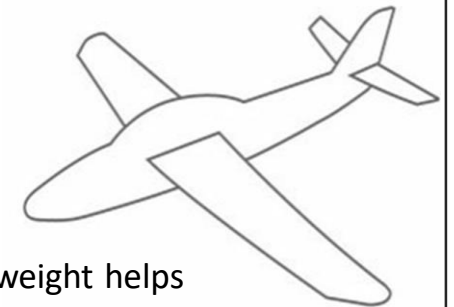

Adding the weight helps
the glider fly properly.

6

Make the launcher handle by gluing two pieces of cardboard together. This will make sure it is durable enough to use. Make sure the cardboard is a comfortable size so you can hold it securely.



Once the glue is dry, cut a notch in the handle.

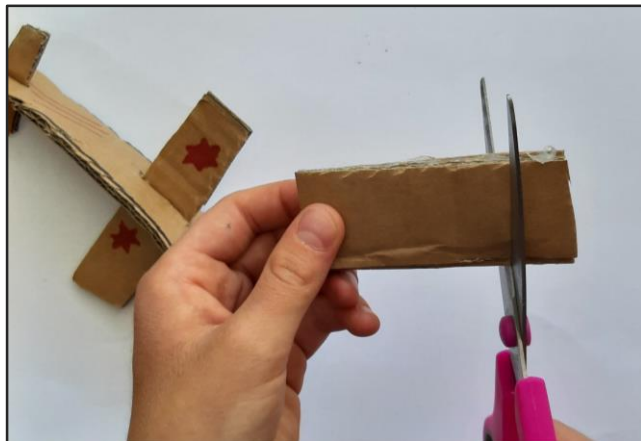

YOUR GLIDER IS NOW READY TO LAUNCH

**To fly your glider stretch a rubber band between the notch in the handle and the glider.
Tilt the glider upwards and release.**



**Use your glider in open spaces.
Never aim your glider towards people or pets.**